

Twin Adapter WMB-VA0.x/1.x-TA

Datasheet.

Features.

Compatible

with all cameras of the ExCam Series
with the model-keys T08-VA0.x und T08-VA1.x
and the RoughCam Series T10-VA0.x, T10-VA 1.x.
For easy mounting of 2 cameras.

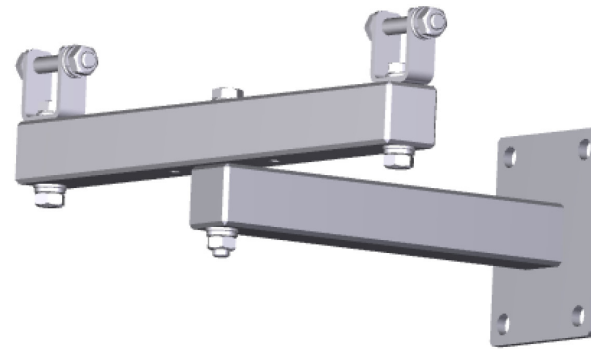

Data.

Mechanical characteristics

Material:	Stainless steel AISI 316L/1.4404
Weight:	1.35 kg
Load:	25 kg
Dimensions WxHxD [mm]:	300x132x205
Manual pan angle:	360°
Manual tilt angle:	90°

Scope of delivery Includes WMB-VA0.x/VA1.x, 2 hinge attachments and mounting material

Dimensions [mm].

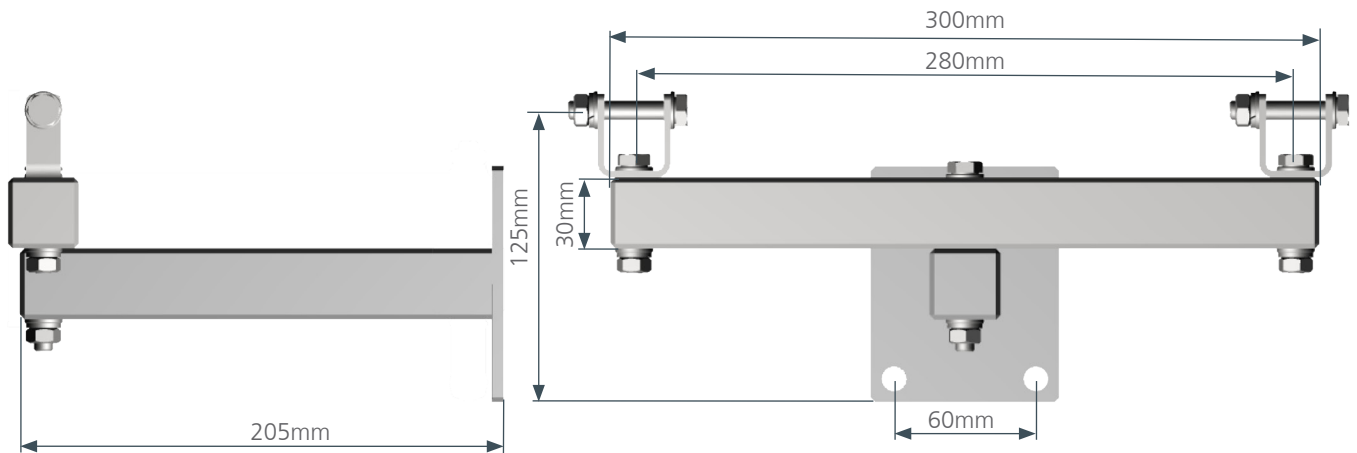

Schillerstrasse 17
D-35102 Lohra-Altenvers

info@samcon.eu
T: +49 6426 9231-0
F: +49 6426 9231-31

© SAMCON GmbH All rights and technical changes reserved. No liability for wrong or missing data..